

625PM STANDARD AXLE ASSEMBLY

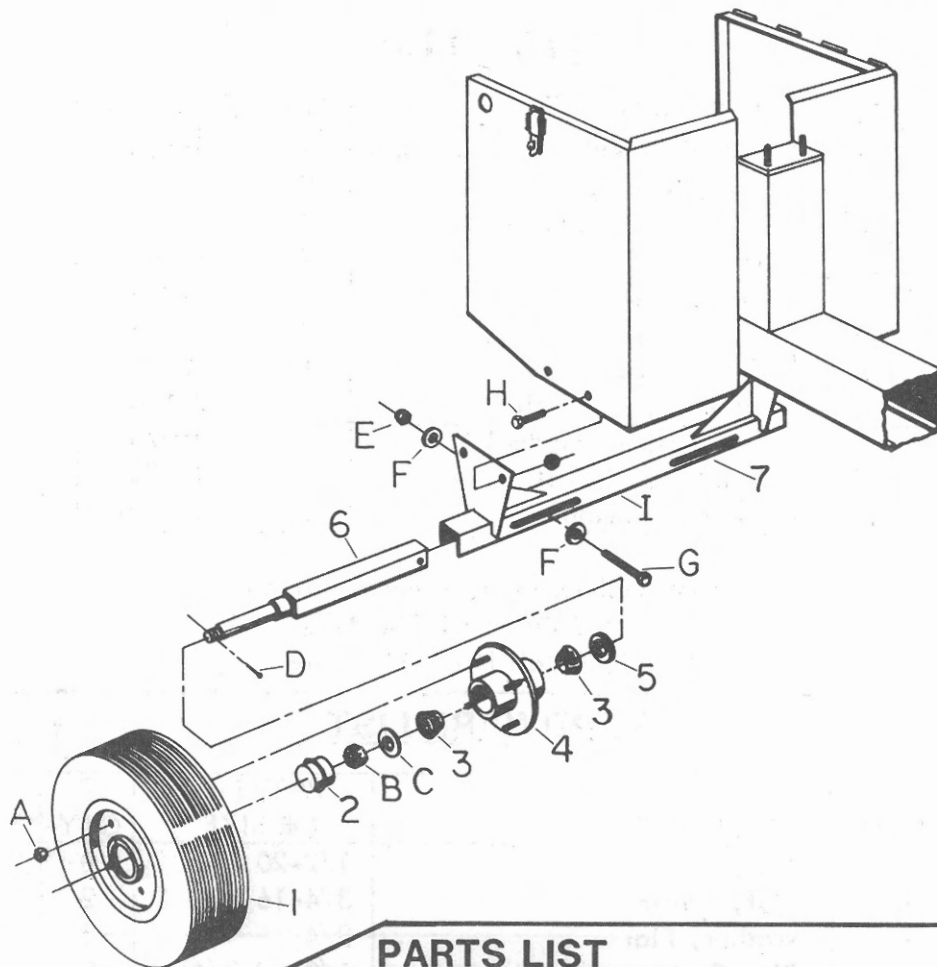

PARTS LIST

ITEM	DESCRIPTION	QTY	PART NO.
1	Tire & Wheel Assy. 4.80 x 8	2	34605
2	Cap, Bearing	2	34573
3	Bearing, Tapered Roller	4	32051
4	Hub	2	34501
5	Seal, Wheel	2	32052
6	Half - Axle	2	27543
7	Axle Support	1	27544

HARDWARE LIST

ITEM	DESCRIPTION	PART NO. OR SIZE	QTY
A	Nut, Lug	1/2-20	8
B	Nut, Castle	3/4-16	2
C	Washer, Flat	3/4	2
D	Pin, Cotter	1/8 x 1 3/4	2
E	Nut, Nylock	7/16-14	2
F	Washer, Flat, Plain	7/16	4
G	Bolt, Hex Head	7/16-14 x 3	2
H	Bolt, Hex Head	1/2-13 x 1 1/4	4
I	Nut, Nylock	1/2-13	4